

# VitrA

Concealed Cisterns and Control Panels

High  
quality,  
maximum  
functionality!



VitrA



# Practical solutions for aesthetic bathrooms



## **Hygienic:**

By offering assembly solutions that are concealed in the wall Vitra concealed cistern enables easy cleaning without the clutter of visible connecting pipes or intermediary hoses. The height gained by using a wall-hung WC pan creates an empty space under the pan, making it very easy to clean.



## **Quiet:**

Thanks to the special filling group used inside, the concealed cistern works quietly. The Styrofoam coat provides extra insulation.



## **Transportation:**

Has been subjected to a road transportation test of over 6000 km under difficult conditions.

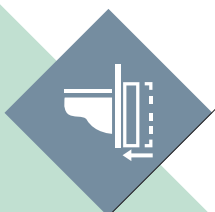

## **Saves Space:**

As the cistern is concealed behind the wall and under the plasterwork, you save precious space, resulting in a wider bathroom. With concealed in-wall installation solutions, space is saved and more living space is provided.



## **Saves Water:**

WC pan-cistern systems prevent unnecessary water consumption with their special bowl structures and concealed cistern float valves that ensure low water consumption. With its two-stage flush function, the concealed cistern results in water savings up to 70 percent in the 2.5/4L and 3/6L options.



## **Easy Maintenance:**

With a warranty period of five years, these products come with a guarantee against any failure. With control panels that are easily mounted and dismantled, access to the sub-plaster installations is easy.



## **Practical and Fast Assembly:**

The special parts and systems of the concealed cistern enable easy and quick assembly. This feature provides an important advantage, especially for high-volume assembly jobs.

# Functional Solutions



## **Overflow Test:**

The overflow pipe in the flushing mechanism is the safety valve of the cistern. The discharge performance of the pipe is checked in a test that is done periodically with water sent through the pipe at dynamic pressure, designated by standards.



## **Weight Test - 400 kg Weight Bearing Test:**

Cisterns used with wall-hung WC pans must be able to bear 400 kg, as they are expected to carry not only the user's weight but also any other force that may be applied onto them. To this end, concealed cisterns mounted on the walls of various specially designed wall types at laboratories are checked periodically with special testing apparatuses.

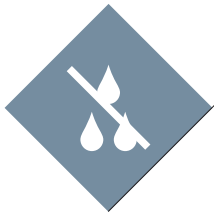

## **Leak Test:**

All our products are subjected to leak tests by filling water into the cistern at Vitra production facilities.



## **Flow Rate Test:**

The amount of water coming into the cistern during flushing must be at a standard level. If the water flushing rate of the cistern is below standards, the WC pan will not be fully cleaned. Hence, all products go through quality control by Vitra technicians and are periodically tested for flow rates conforming to international standards (2 l/sec).

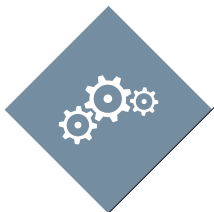

## **Functionality Test:**

All products are subjected to tests according to their specifications. For example: in pneumatic products function of bridges with air transmitted, operation of 3/6 litres flush plate of panels, function of mechanical spring panels, operation of panel sensors in photocell controlled panels and function of 3/6 lt flush mechanisms are %100 controlled.



## **Life Test:**

Products are periodically subjected to life tests that are to world standards. Consecutively operated 200,000 times, the products must prove that there is no drop in the performance of any parts.



## **Green building certification:**

These products fulfill Green building certification (LEED, BREEAM and DGNB) criteria with their environmentally-friendly features including lower environmental footprint, water conservation and the use of local materials as well as life cycle assessment (LCA), environmental product declaration (EPD) and sustainable forestry (FSC), certificates. They are recommended for projects aiming for a Green building certification.





# Great collection in **high quality!**

Through the plurality of quality testing, Vitra offers functional products in high quality and durability.

Frequently used and remaining normally subjected to more pressure in the extra strengthening new collection of Vitra offers long-lasting use.



Control Panel &  
Concealed  
Cistern

**10** years  
warranty\*

## Product

## Product Specifications



**760-1720-01IND**

Concealed Cistern

### Short Concealed Cistern Rapid installation set (Pre-wall gypsumplate) 85 cm height, assembly to wall Adjusted to 3/6 L

- Suitable for wall-hung WC pans
- Front/top operated
- Mechanic
- Dual flush
- Full frame available with 760-5805-01IND

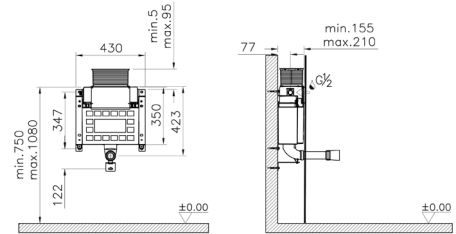

**748-1730-01IND**

Concealed Cistern

### Standard installation set for wall-hung WC pans (8 cm. thickness) Adjusted to 3/6 Lt.

- Suitable for wall-hung WC pans
- Front operated
- Mechanic
- Pneumatic usage is also available
- Dual flush

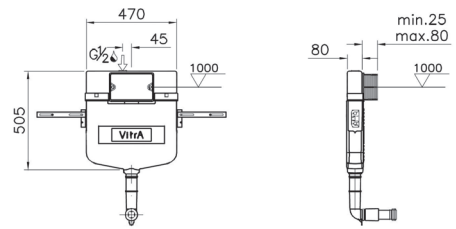

**748-1800-01IND**

Concealed Cistern

### Standard installation set, for wall-hung WC pans Adjusted to 3/6 L

- Suitable for wall-hung WC pans
- Without metal brackets
- Front operated
- Mechanic
- Pneumatic usage is also available
- Dual flush

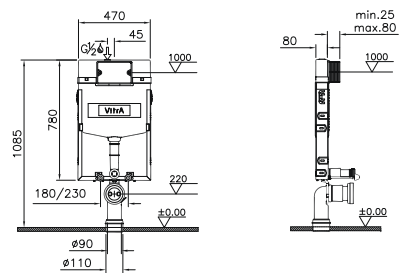





### Standard installation set for wall-hung WC pans

- Suitable for wall-hung WC pans
- Includes metal brackets to adjust height easily
- Front operated
- Mechanic
- Pneumatic usage is also available
- Dual flush

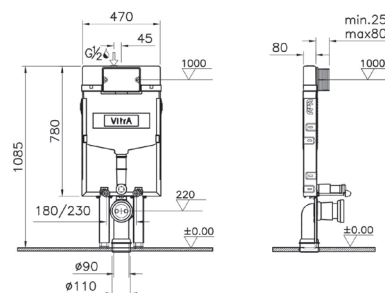

**Rapid installation set, for wall-hung WC pans**

- Front operated
- Mechanic
- Pneumatic usage is also available
- Dual flush

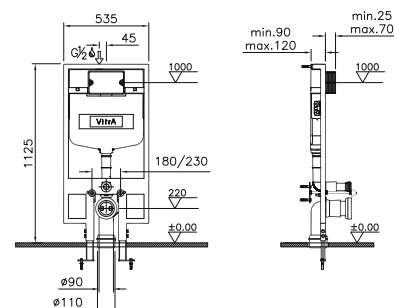
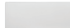

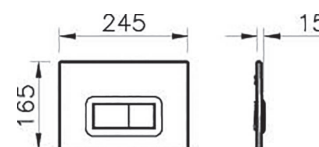

Plate / Shiny Chrome, ABS  
Push Buttons / Shiny Chrome, ABS  
• Mechanic control  
compatible with 748-XXXX-XXIND  
concealed cisterns

Options		
Code	740-0685IND	740-0611IND
Plate	Matte Chrome, ABS	Black, ABS
Push Buttons	Matte Chrome, ABS	Black, ABS





**740-0480IND**

Control Panel

**SIRIUS Control Panel**

Plate / Shiny Chrome, ABS  
 Push Buttons / Shiny Chrome, ABS  
 Ring / Matte Chrome, ABS  
 • Mechanic control  
 compatible with  
 748-XXXX-XXIND concealed cisterns

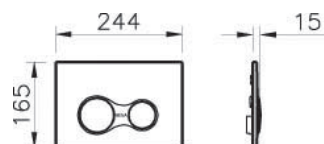
Options		
Code	740-0485IND	740-0411IND
Plate	Matte Chrome, ABS	Black, ABS
Push Buttons	Matte Chrome, ABS	Black, ABS



**740-0785IND**

Concealed Cistern

**LOOP T Control Panel**

Plate / Matte Chrome, ABS  
 Push Buttons / Matte Chrome, ABS  
 • Mechanic control  
 compatible with 748-XXXX-XXIND  
 concealed cisterns

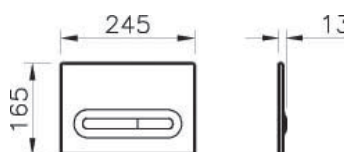
Options		
Code	740-0780IND	740-0711IND
Plate	Shiny Chrome, ABS	Black, ABS
Push Buttons	Shiny Chrome, ABS	Black, ABS



**740-0585IND**

Concealed Cistern

**LOOP O Control Panel**

Plate / Matte Chrome, ABS  
 Push Buttons / Matte Chrome, ABS  
 • Mechanic control  
 compatible with 748-XXXX-XXIND  
 concealed cisterns

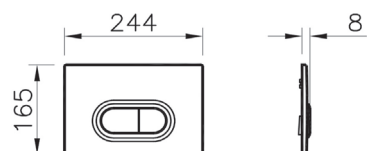
Options		
Code	740-0585IND	740-0511IND
Plate	Shiny Chrome, ABS	Black, ABS
Push Buttons	Shiny Chrome, ABS	Black, ABS



**748-0180IND**

Control Panel

**TWIN<sup>2</sup> Control Panel**

Plate / Shiny Chrome, ABS  
 Push Buttons / Shiny Chrome, ABS  
 • Pneumatic control  
 compatible with  
 748-XXXX-XXIND concealed cisterns

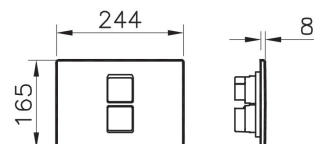
**748-0102IND**

Control Panel

**TWIN<sup>2</sup> Control Panel**

Plate / White, ABS  
 Push Buttons / Gold Plated, ABS  
 • Pneumatic control  
 compatible with  
 748-XXXX-XXIND concealed cisterns

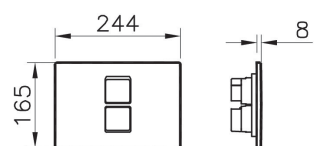

Options			
Code	748-0101IND	748-0111IND	748-0112IND
Plate	White, ABS	Black, ABS	Black, ABS
Push Buttons	Shiny Chrome, ABS	Shiny Chrome, ABS	Gold Plated, ABS

**740-1100IND**

Control Panel

**SELECT Control Panel**

Plate / White, Tempered Glass,  
 Push Buttons / Shiny Chrome, ABS  
 • Mechanic control  
 compatible with  
 748-XXXX-XXIND concealed cisterns

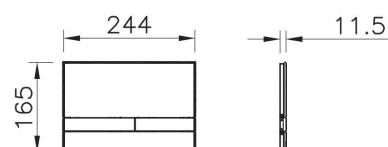

Options	
Code	740-1101IND
Plate	Black, Tempered Glass, ABS
Push Buttons	Shiny Chrome, ABS

## Product

## Product Specifications



**720-1730-01IND**

Concealed Cistern

### Uno standard installation set for wall-hung WC pans

Adjusted to 3/6L

- Suitable for wall-hung WC pans
- For suitable wall application
- Front operated
- Mechanical operation
- Dual Flush

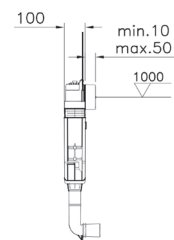
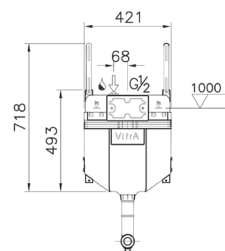

**720-1800-01IND**

Concealed Cistern

### Uno standard installation set for wall-hung WC pans

Adjusted to 3/6L

- Suitable for wall-hung WC pans
- Without metal brackets
- For suitable wall application
- Front operated
- Mechanical operation
- Dual Flush

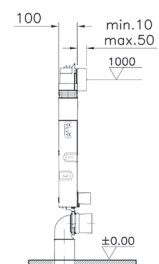
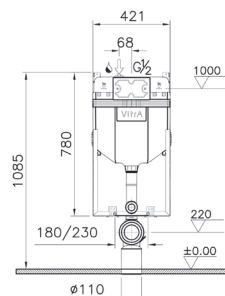

**720-1851-01IND**

Concealed Cistern

### Uno standard installation set for wall-hung WC pans with adjustable thin metal brackets

Adjusted to 3/6L

- Suitable for wall-hung WC pans
- Includes thin metal brackets to adjust height easily
- For suitable wall application
- Front operated
- Mechanical operation
- Dual flush

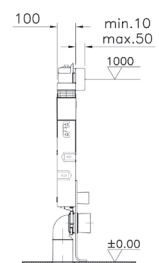
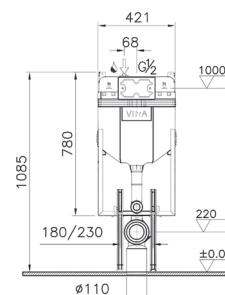

## Product

## Product Specifications



**720-5800-01IND**

Concealed Cistern

### Uno rapid installation set for wall-hung WC pans wall mounted

Adjusted to 3/6L

- Suitable for wall-hung WC pans
- For suitable wall application
- Front operated
- Mechanical operation
- Dual flush

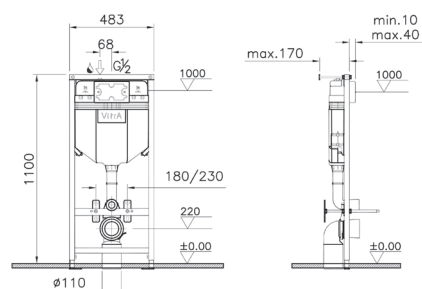

**720-0100IND**

Control Panel

### Uno Mechanic Control Panel White

Plate / White, ABS

Push Buttons / White, ABS

- Mechanic control compatible with 720-XXXX-XXIND concealed cisterns



Options		
Code	720-185IND	720-180IND
Plate	Matte Chrome, ABS	Shinny Chrome, ABS
Push Buttons	Matte Chrome, ABS	Shinny Chrome, ABS



**720-0200IND**

Control Panel



### Uno Mechanic Control Panel White

Plate / White, ABS

Push Buttons / White, ABS

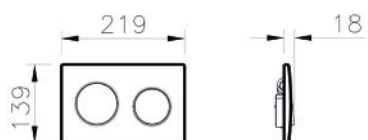
- Mechanic control compatible with 720-XXXX-XXIND concealed cisterns



Options		
Code	720-285IND	720-280IND
Plate	Matte Chrome, ABS	Shinny Chrome, ABS
Push Buttons	Matte Chrome, ABS	Shinny Chrome, ABS

		Application walls			Suitable control panels			
Product code		Brick-wall	Pre-wall (Gypsumplate coverage)	Light weight construction walls (Gypsumplate coverage)	748-0201IND 748-0101IND 748-0111IND 748-0112IND 748-0180IND	740-0480IND 740-0411IND 740-0485IND 740-0580IND 740-0511IND 740-0585IND 740-0680IND 740-0611IND 740-0685IND	740-1100IND 740-1101IND 740-0780IND 740-0711IND 740-0785IND	720-0200IND 720-0285IND 720-0280IND 720-0100IND 720-0185IND 720-0180IND

Standard mounting concealed cisterns	760	5805-01IND 1720-01IND		X			X		
	748	1800-01IND 1800-02IND	X X			X	X	X	
	748	1850-01IND 1850-02IND	X X			X	X	X	
	748	1730-01IND 1730-02IND	X X			X	X	X	
	720	1730-01IND	X						X
	720	1851-01IND	X						X
Rapid mounting concealed cisterns	748	5800-01IND 5800-02IND		X X		X	X	X	
	720	5800-01IND		X					X
	720	1800-01IND		X	X				X

#### \*Warranty Table

- Concealed Cisterns: 10 years
- Cistern Mechanism (Plastic Parts): 10 years (gaskets 5 years)
- Mechanical & Pneumatic Control Panels: 10 years
- Photocell Controlled Concealed Cisterns & Panels : 2 years



### Head Office

VitrA Bathroom Group  
Eczacıbaşı Yapı Gereçleri  
San. ve Tic. A.Ş.  
Ali Kaya Sok. No: 7  
34394, Levent, İstanbul / Turkey  
[www.vitra.com.tr](http://www.vitra.com.tr)

### India Offices

**Mumbai**  
EYAP Liaison Office  
B-102, Durolite House,  
Opp. SAB TV Building,  
New Link Road, Andheri (West)  
Mumbai, INDIA 400 053  
Phone: +91-22-6708 5000  
[www.vitra-india.com](http://www.vitra-india.com)

**New Delhi**  
A - 288, Defense Colony,  
Ground Floor,  
New Delhi – 110024  
Phone: +91-11-4052 5900  
[www.vitra-india.com](http://www.vitra-india.com)





VitrA